

INSTALLATION INSTRUCTIONS

Flow Switch & Temperature/ Pressure Gauge

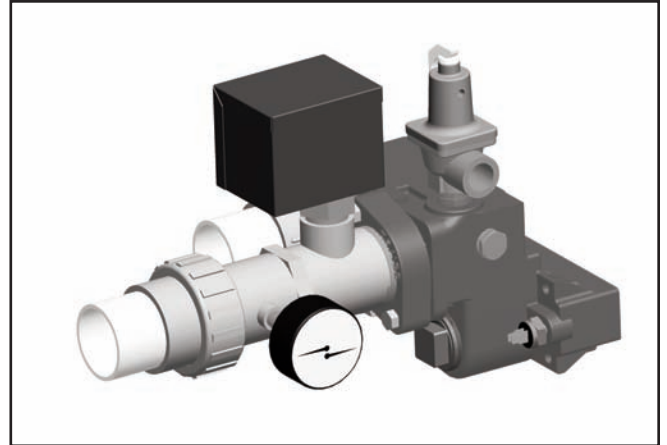

**For Atmospheric
Models C-R206AE-406AE**

**For Low NOx
Models C-R207AE-407AE**

FOR YOUR SAFETY: Do not store or use gasoline or other flammable vapors and liquids or other combustible materials in the vicinity of this or any other appliance. To do so may result in an explosion or fire.

WHAT TO DO IF YOU SMELL GAS:

- Do not try to light any appliance.
- Do not touch any electrical switch; do not use any phone in your building.
- Immediately call your gas supplier from a neighbor's phone. Follow the gas supplier's instructions.
- If you cannot reach your gas supplier, call the fire department.

Installation and service must be performed by a qualified installer, service agency or the gas supplier.

NOTE: Not for use with millivolt units.

NOTE: These instructions are intended primarily for use by qualified personnel specifically trained and experienced in the installation of this type of heating equipment and related system components. Installation and service personnel must be licensed in some states. Persons not qualified shall not attempt to install this equipment nor attempt repairs according to these instructions.

DANGER - SHOCK HAZARD: Make sure electrical power to the heater is disconnected to avoid potential serious injury or damage to components.

Kit Contents

Each kit includes:

- (1) Temperature and Pressure gauge
- (1) Pre-wired Flow Switch with outdoor cover
- (2) Paddles
- (1) Screw, #6-32 x 3/16
- (1) 2" CPVC Tailpiece Connector
- (1) 2" CPVC Manifold Adapter
- (1) O-Ring
- (2) Female spade terminals
- (1) Ring nut

This kit is primarily intended for jurisdictions requiring the addition of a flow switch and/or temperature and pressure gauge on pool heaters.

Before Starting

- 1) Turn off power to the heater at the circuit breaker.
- 2) Turn off gas supply.
- 3) Shut off the water supply to the heater.
- 4) Allow heater to cool down before attempting work.

INSTALLATION

1. Remove main front panel door and set aside.
2. Remove the front control panel screws (2 each located at the ends of the panel). Lower front panel to expose the main circuit board.
3. Remove transformer cover located on either the upper right or left side.
4. Locate conduit opening above power conduit opening on the waterside of the heater.
5. Locate the Inlet/Outlet header.
6. Install 2" flanges to header ports, if not already installed.

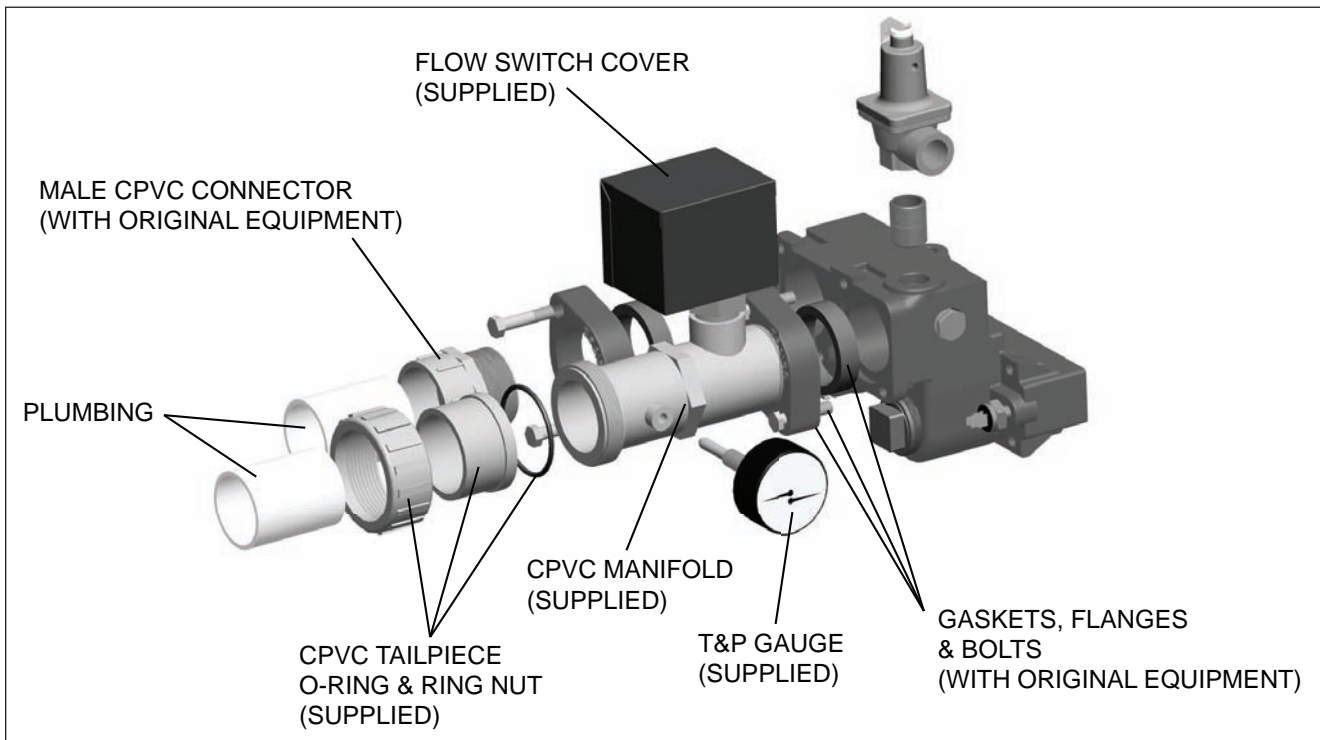

Fig. 1: Flow Switch and Temperature and Pressure Gauge

7. Locate and install the 2" CPVC manifold adapter onto the Outlet side (see Fig.1). Careful not to strip the threads on the manifold adapter.
8. Locate the flow switch, (2) paddles and (1) #6-32 screw.
9. Using a Phillips screw driver, install the correct paddle size to the flow switch.

	Models 206, 207 266, 267	Models 366, 367 406, 407
Paddle Size	1.88" LG (Longer paddle)	1.8" LG (Shorter paddle)
Paddle ID	"F"	"A"

10. Install flow switch onto manifold adapter.
11. Be sure to verify the flow switch is positioned correctly to sense the proper direction of the water flow, out of the heater.
 - a. The arrow on the flow switch indicates the direction of flow.

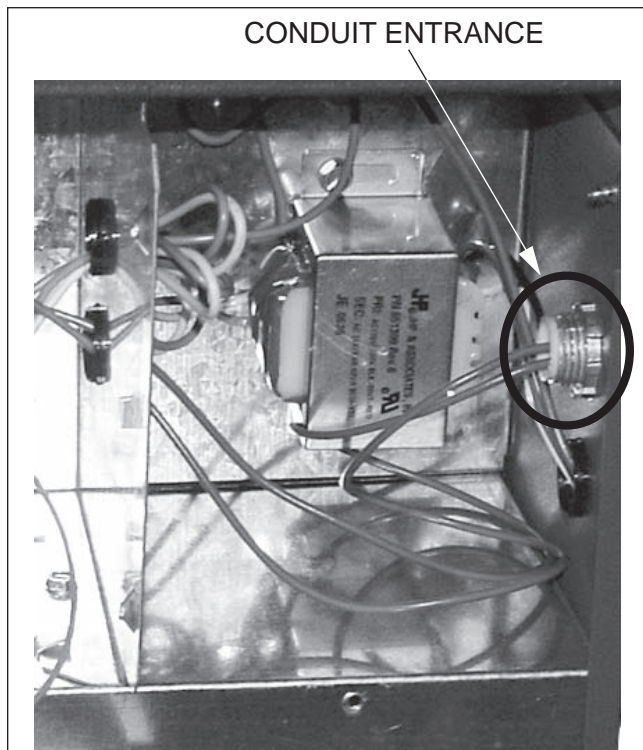

Fig 2: Transformer Box

12. Locate and install the flow switch cover, if not already installed.
13. Locate and install the T&P gauge on the side of the manifold adapter (see Fig.1).
14. Use the CPVC tailpiece, o-ring and ring nut to connect to your outlet plumbing.
15. Using the original equipment male CPVC connector, install your inlet plumbing.
16. Locate the pre-wired hard conduit off the flow switch and route through the upper control panel as indicated in Fig 2.
17. Cut the white "spare" jumper located on the back of the circuit board in the upper control panel. See Fig. 3.
18. Strip 1/4" of insulation from each end of the white "spare" jumper cut in the previous step. Install and crimp a female spade connector (supplied in kit) on each stripped end.
 - a. Ensure the connectors being crimped are of the proper size and shape to accept the connectors on the end of the wire harness.
 - b. Ensure the crimp is tight.

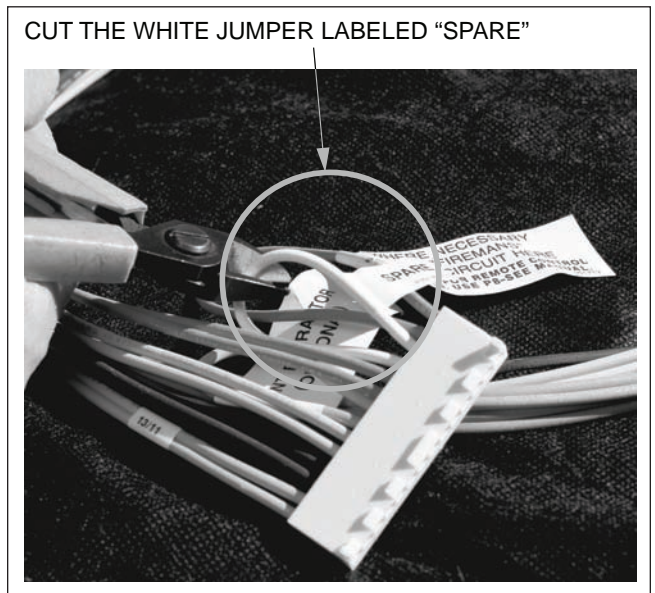

Fig 3: Cutting the Jumper Wire

19. Plug the connectors from the flow switch wire harness into the connectors just installed on the white "spare" jumper. See Fig. 4.
20. Reinstall the sheet metal transformer cover.
21. Close front control panel and reinstall the four screws (two at each end).
22. Reinstall front main panel door onto the heater.
23. Turn water on to the heater and check for leaks.
 - a. If leaks are found, repair immediately.
24. Turn on gas to the heater.
25. Turn on power to the heater.
26. Cycle the heater a few times to verify flow switch operation.



Fig 5: Completed Assembly

FLOW SWITCH WIRES
CONNECTED TO "SPARE" JUMPER

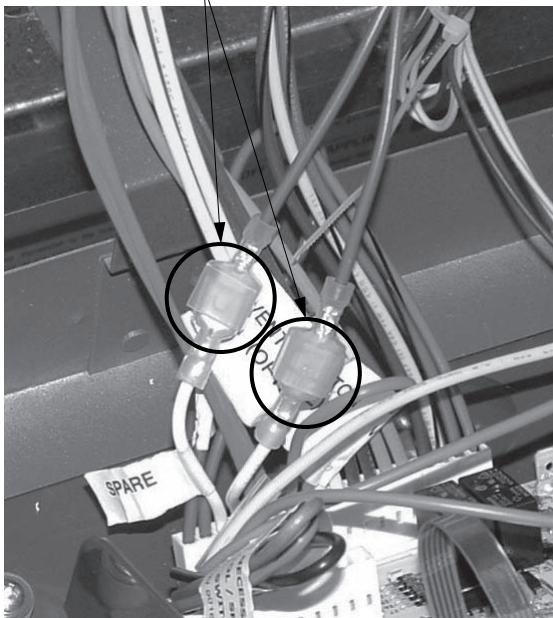

Fig 4: "Spare" Jumper Connections



www.raypak.com

Raypak, Inc., 2151 Eastman Avenue, Oxnard, CA 93030 (805) 278-5300 Fax (805) 278-5468
Litho in U.S.A.