

# Senior Commercial Instructions

First construct the tubing as per the instructions included in the tube box.

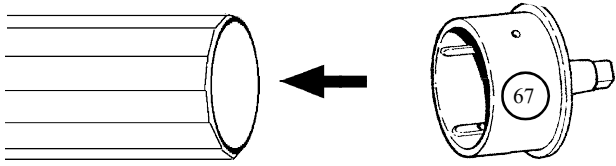

Insert 4" hub (item #67) into one end of tube.

With 2 self-drill/tapping screws (item #1), attach hub to tube using **electric drill**. Apply pressure to ensure screw cuts into aluminum tube then cuts it's own thread.

**(No predrilling required) Repeat with other side.**

SELF-DRILLING

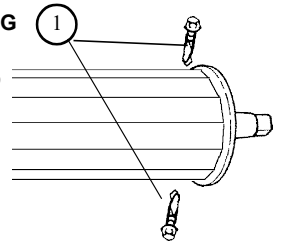

## 1 Assemble the end units

Bolt the castors (item #211) to the A-frames (item #55) and to the 3rd leg frame (item #63), as shown in the diagram. Next, bolt the 3rd leg frames (item #63) to the A-frames (item #55). Assemble one end unit to the tube, using the large handle (item #73), as shown in the diagram.

Assemble the other end unit to the tube, using the white knob (item #61).

For smoother operation, apply petroleum based grease between the hub (item #67) and the black plastic bushing (item #105). This should be done once a year.

Position the assembled roller unit at the widest end of the pool.

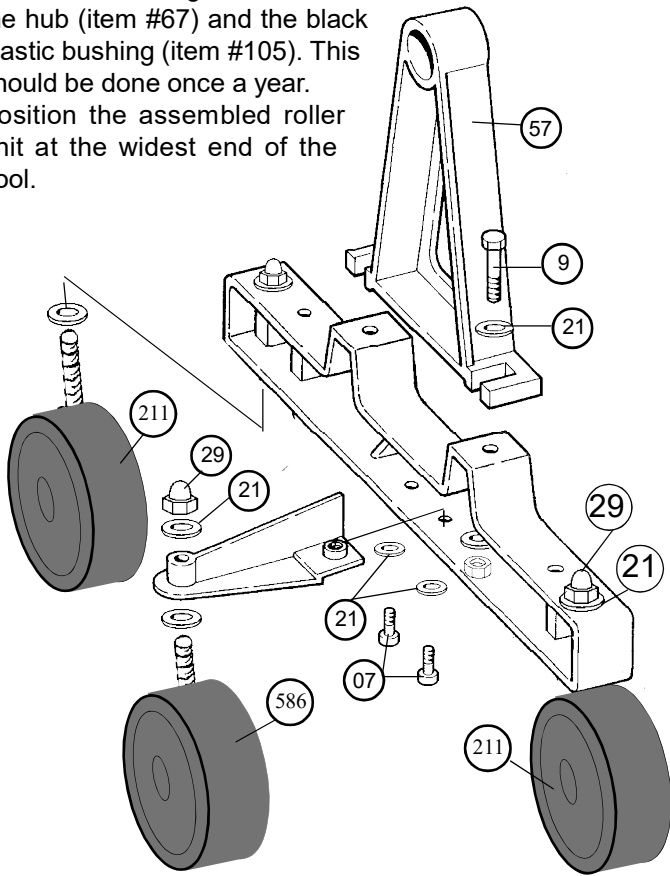

## 2 Assemble the system

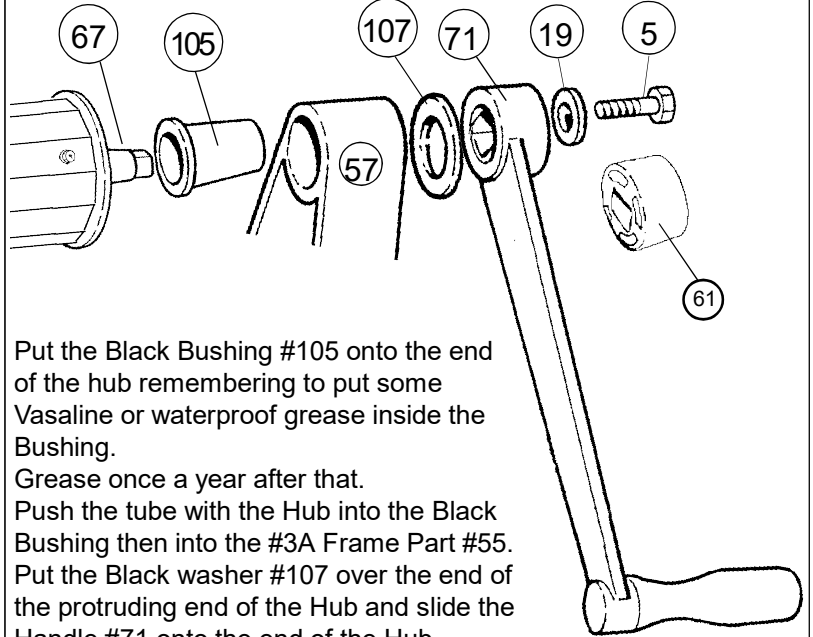

Put the Black Bushing #105 onto the end of the hub remembering to put some Vasaline or waterproof grease inside the Bushing.

Grease once a year after that.

Push the tube with the Hub into the Black Bushing then into the #3A Frame Part #55. Put the Black washer #107 over the end of the protruding end of the Hub and slide the Handle #71 onto the end of the Hub.

Put the washer #19 on the Bolt #5 and secure the Handle.

**NOTE** do not overtighten this bolt as it will make it hard to rotate the handle.

Repeat this on the other end of the unit and

## 3 Positioning your Reel System

For **regular** shaped pools, align the outside edge of the tube parallel with the end of the pool.

For **irregular** shaped pools, the outside edge of the tube should be a **minimum** of 3' inside from the end of the pool. Place the reel at the widest point if that is possible for a better result

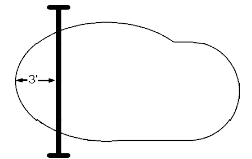
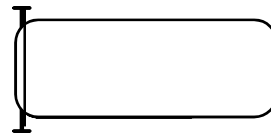

## 4

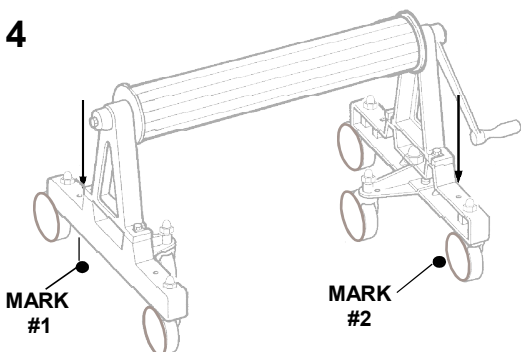

Using one of the two holes in the A-frame as a guide, make mark #1 on deck. With a 1/2" concrete drill bit, drill a 1 1/2" deep hole at mark #1. Complete steps 5 and 6 before continuing with step 4.

On the other side of the roller unit, make mark #2 by using one of the two holes in the A-frame as of guide. With a 1/2" concrete drill bit, drill a 1 1/2" deep hole at mark #2.

**NOTE:**

**Set one bolt at front of frame at one end and one at the rear of the frame at the other end.**

Drive the concrete anchor into the hole with a hammer. Leave the anchor raised 1/16".

To set the concrete anchor, hit the slug with a hammer and center punch or large nail driving the slug down into the anchor forcing legs out into concrete.

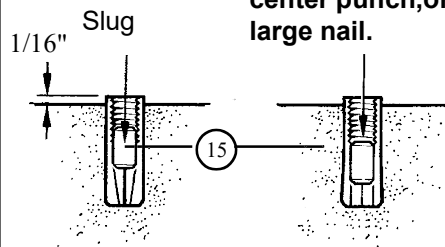

**Hit center slug with hammer & center punch, or large nail.**

## 6

Insert the anchor bolt (item #13) through the spring (item #25), through spring guard (item #109), and through the hole in the A-frame.

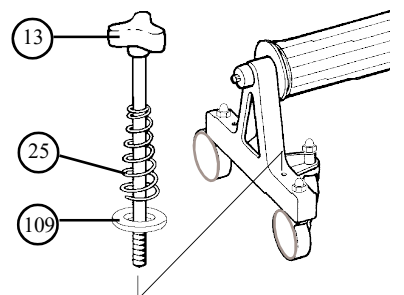

Tighten the anchor bolt.

**NOTE: Do not overtighten**

**FOR REGULAR SHAPED INGROUND POOLS**

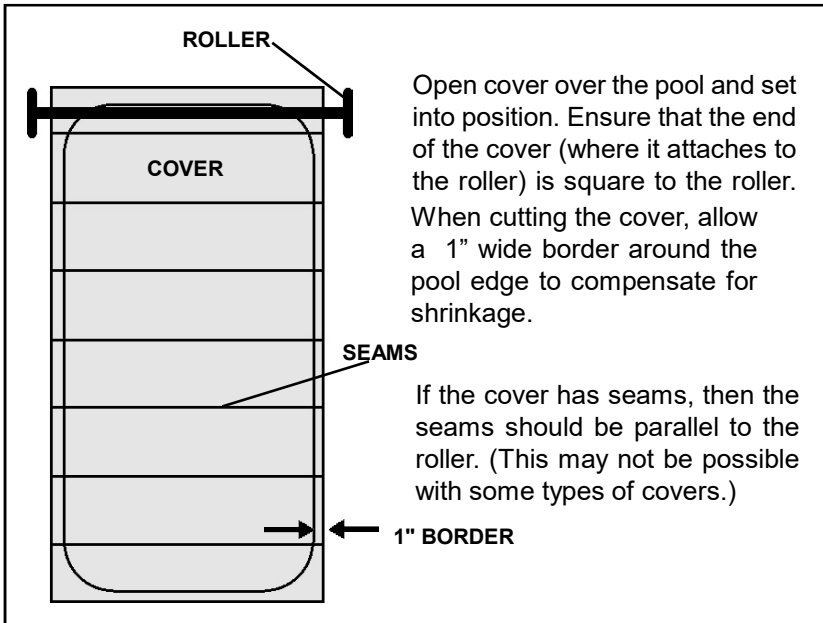

Open cover over the pool and set into position. Ensure that the end of the cover (where it attaches to the roller) is square to the roller. When cutting the cover, allow a 1" wide border around the pool edge to compensate for shrinkage.

If the cover has seams, then the seams should be parallel to the roller. (This may not be possible with some types of covers.)

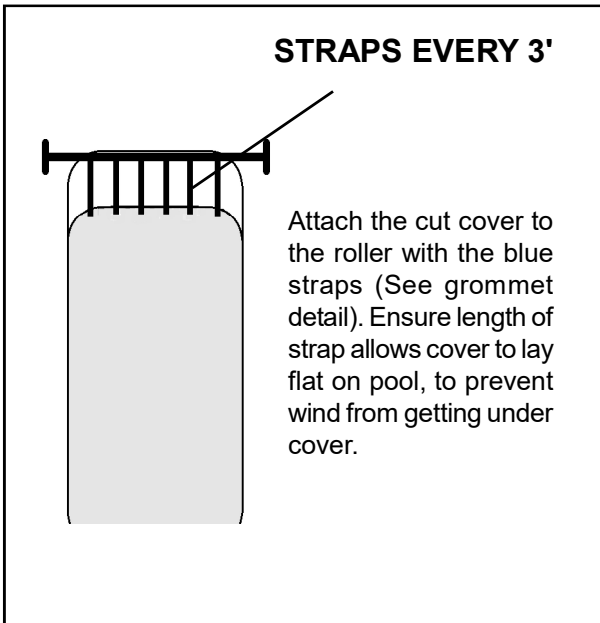

**STRAPS EVERY 3'**

Attach the cut cover to the roller with the blue straps (See grommet detail). Ensure length of strap allows cover to lay flat on pool, to prevent wind from getting under cover.

**FOR IRREGULAR, KIDNEY, OR ROUND SHAPED INGROUND POOLS**

Open cover over the pool and set into position. Ensure that the seams on the cover are parallel to the roller. (This may not be possible with some types of covers).

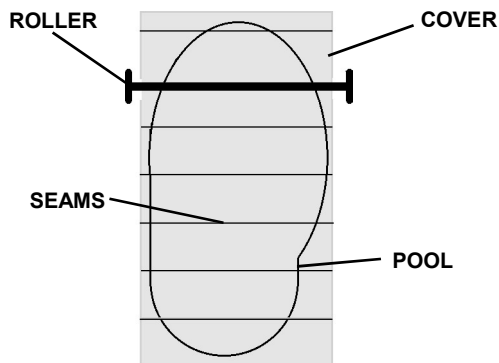

When cutting the cover, allow a 1" wide border around the pool edge to compensate for shrinkage.

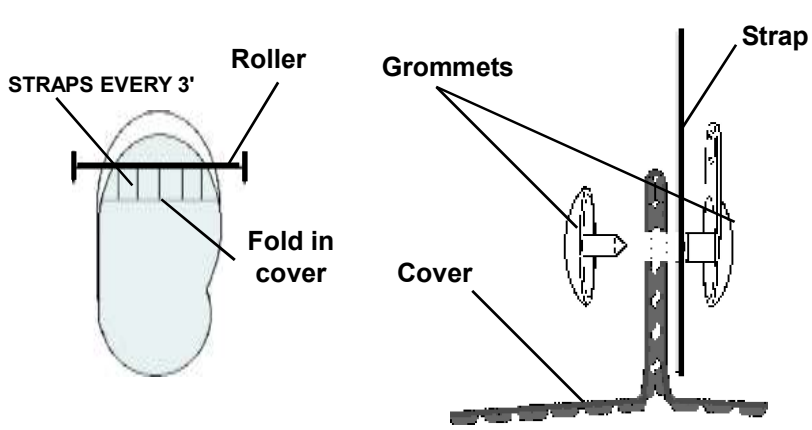

For odd shaped pools, pinch the cover and attach the strap as shown. Attach the cut cover to the roller with the blue straps (see grommet detail) by folding the cover in a straight line as shown in the diagrams. Ensure that the fold in the cover is straight.

**GROMMET DETAIL**

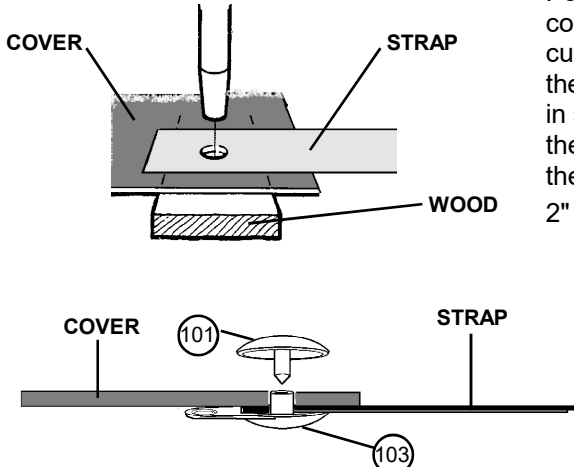

Position the blue strap on the cover. Make a hole, or cross cut through the strapping and the cover. Ensure that the hole in strapping is at least 2" from the end of the strap and that the hole in the cover is at least 2" from the end of the cover.

Insert female grommet (item #103) through hole in strapping and cover. Ensure that material is completely pushed down shaft. Insert male grommet (item #101) into female grommet. Once in place, hit with hammer until secure. (Caution - excess force may break grommet).

**This box contains**

ITEM #	QTY	DESCRIPTION	RE-ORDER #
1	16	Self-tapping Screw	501
5	2	5/16"x1" Bolt	505
7	4	3/8" x 1" Bolt	507
9	4	3/8" x 1.5" Bolt	509
13	2	3/8"x8" Anchor Bolt	513
15	2	Concrete Anchor	515
19	2	5/16" Washer	505
21	20	3/8" Washer	21
25	2	Spring	517
29	6	Acorn Nut	523
31	4	3/8" Nut	525
57	2	#4 A-Frame	57
59	2	SR Base Frame	59
61	1	White Knob	533
63	2	3rd Leg Frame	535
67	2	4" Hub	539
73	1	Large Handle	547
101	12	Male Grommet	549
103	12	Female Grommet	549
105	2	Black Plastic Bushing	555
107	2	Black Plastic Washer	555
109	2	Black Spring Guard	109
203	1	36' Strapping	589
211	4	4" Wheels	585
	2	3rd Leg 4" Casters	586

**Tools Required:**

Reversible Drill
1/2" Concrete (masonry) Drill Bit
Hammer & Center Punch (or large nail)
5/16" Hex Head Socket Bit
1/2" Wrench
5/8" Wrench
9/16" Wrench

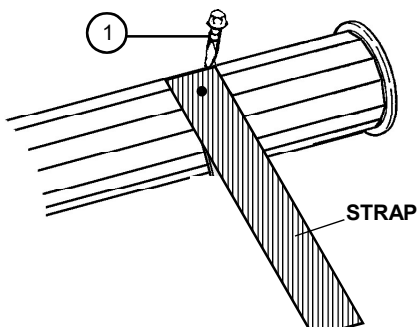

Using self-tapping/drill screws (item #1), secure strap to tube.

**Rocky's Reel Systems Inc.**

Tel: 1-800-663-8705

E-Mail: [info@rockys.ca](mailto:info@rockys.ca)