



# POWER BOX

20  
WATT

120V  
DC

## READ INSTRUCTIONS BEFORE USE



Pedal Power requires physical exercise; ensure you are healthy enough to operate. Consult a physician if you are unsure. Connect only compatible devices. Do not stand on generator. Do not overload.



INSTRUCTIONAL VIDEO & MORE INFO ONLINE: [WWW.K-TOR.COM](http://WWW.K-TOR.COM)

### PARTS

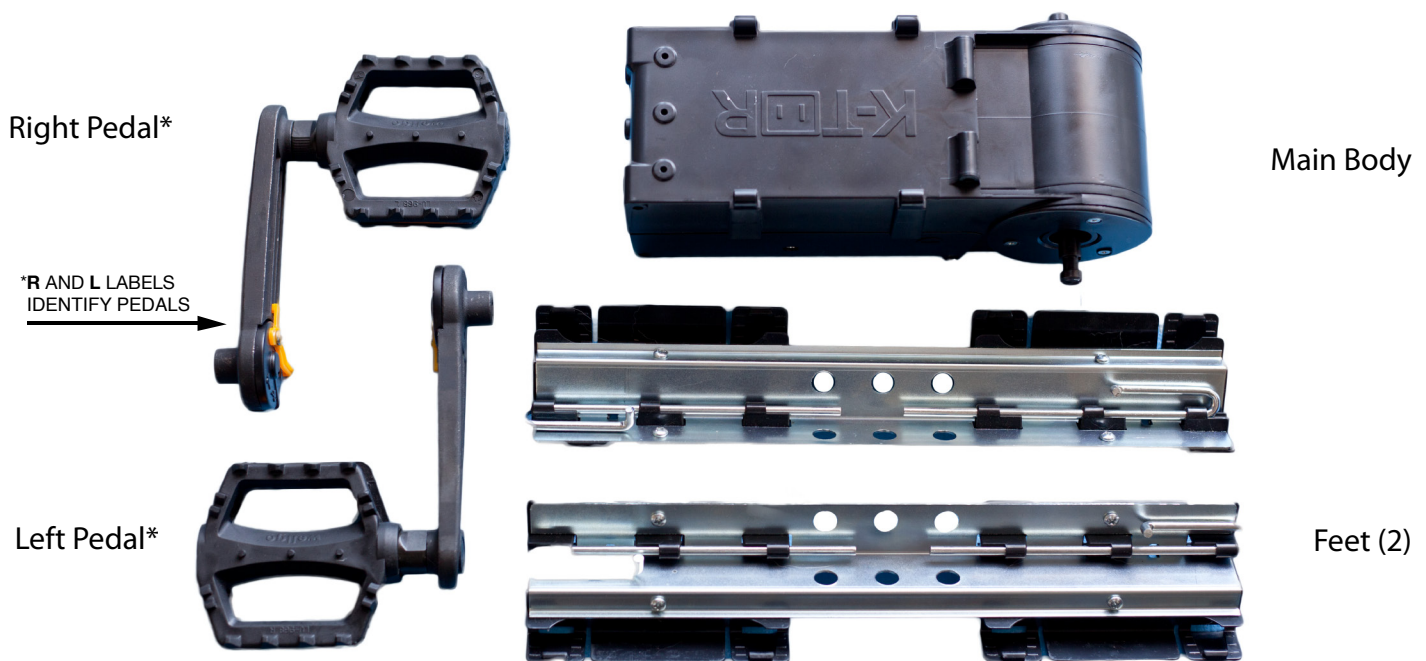

### COMPATIBILITY

The K-TOR Power Box pedal power generator provides DC power and has been designed to be used with devices that accept DC current. Modern consumer electronic devices such as cell phones, tablets, digital cameras, etc., fall into this category. Appliances like a TV, Microwave and Refrigerator require AC power and are not directly compatible with K-TOR generators. To run devices that use AC power or more than 20 Watts of DC power, refer to the advanced charging guide on [k-tor.com](http://k-tor.com).

### WARRANTY

K-TOR provides a one year warranty on all generators sold starting from the date of purchase. The one year warranty covers defects in material and workmanship only. If a unit is found to be defective, K-TOR will repair, replace or refund the unit. To request a warranty claim, contact K-TOR by emailing [info@k-tor.com](mailto:info@k-tor.com). Once a return has been authorized, the unit must be returned to the factory postage prepaid. Do not modify or overload K-TOR generators as this can damage the unit and will void the warranty.

### DISCLAIMER

K-TOR accepts no liability from loss of use, injury or direct or consequential damages as a result of the use or inability to use or failure of K-TOR products.

# CONVERTING FROM STORAGE MODE TO GENERATOR MODE

## UNCLIP PEDALS

1

Detach both pedals by unclipping them from the plastic clips attached to the feet.

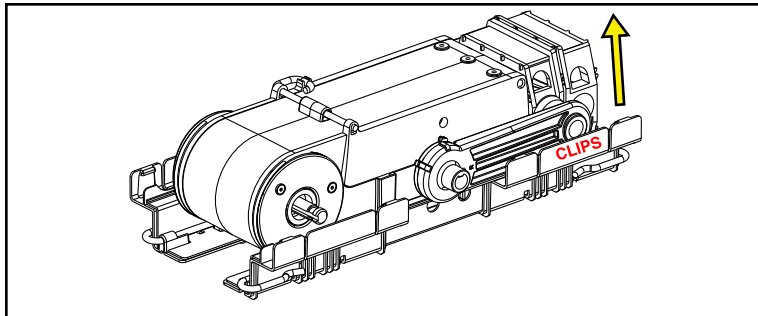

2

## REMOVE FEET

Remove the feet from the generator by pulling out the four feet pins and removing the generator.

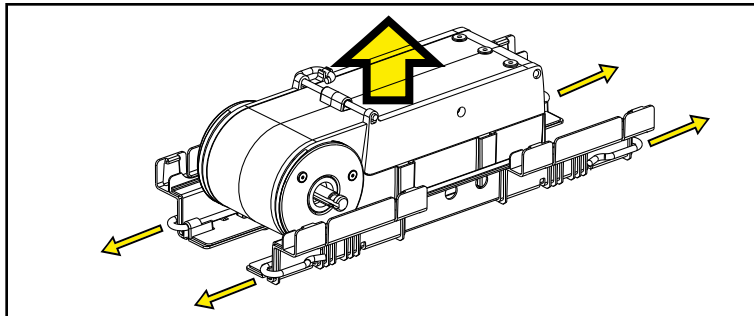

## OPEN BASE

3

Unclip and remove the leg pin. Rotate the leg all the way around and re-insert the pin (stiff when new). Lock in place.

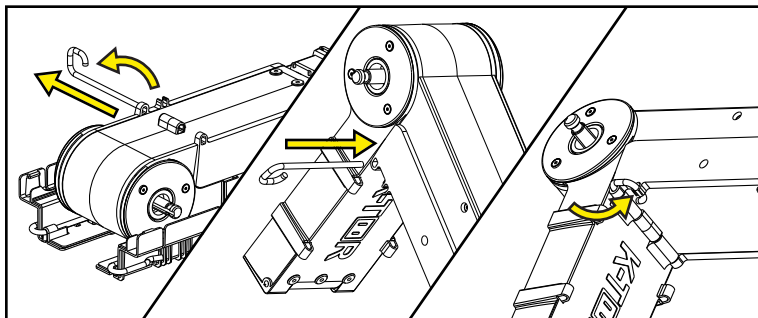

4

## ATTACH FEET

Seat the holes in the generator legs with the holes in the feet. Insert the feet pins to lock in place.

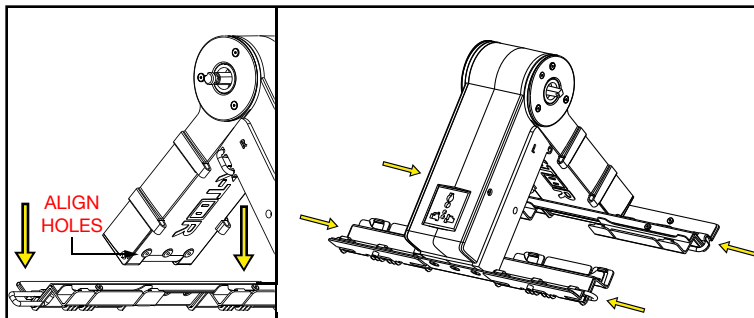

## ATTACH PEDAL

5

The right pedal is marked with an 'R' on the inside of the crank arm. Lift the locking clip and slide the locking disc to the unlocked position. Once unlocked, slide onto crank shaft.

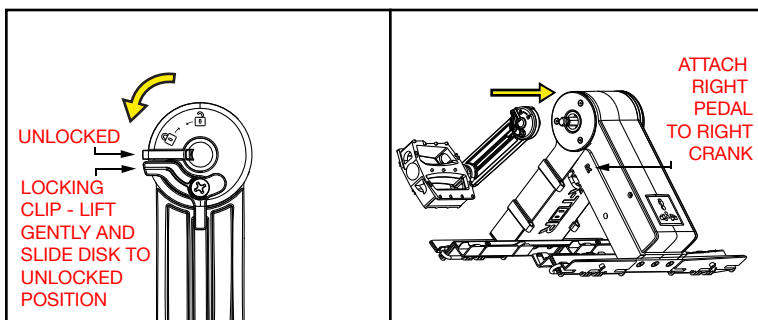

**NOTE:** There is a right and left pedal. It is important they go on the correct side or when pedaling the pedals will loosen and may become damaged.

6

## LOCK PEDAL

Make sure the pedal is fully seated on the crank shaft. With the pedal securely attached to the crank shaft, lock the pedal in place by sliding the locking disc into the locked position.

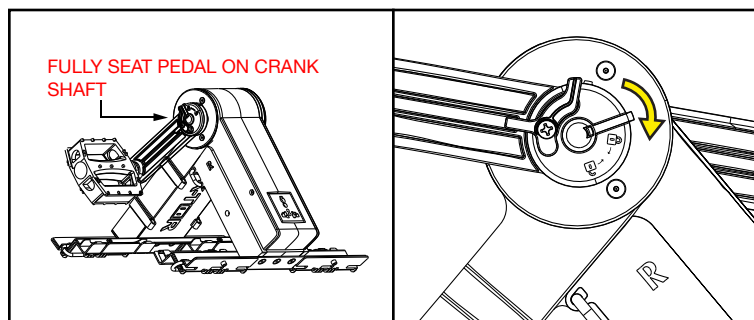

**NOTE:** If the pedals are not in the unlocked position when slid onto the crank shaft, they will not fully seat or properly lock into place.

Repeat steps 5 and 6 to attach the left pedal. The power box is now in generator mode. To return to storage mode, follow the same steps in reverse.

# OPERATING IN GENERATOR MODE

## SETUP

1

The generator can be operated with two hands or two feet and should be spun in a forwards bicycle motion.

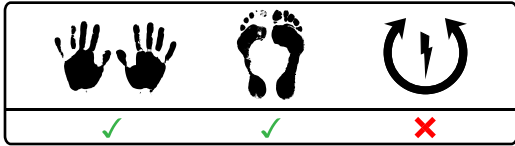

Mounting holes in the generator feet can be used to screw down or stake down the unit for a more stable base. This is highly recommended.

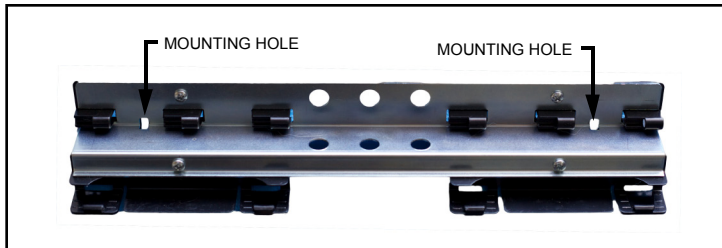

2

## PLUG-IN

Connect a compatible device and its charger directly to the outlet in the K-TOR Power Box pedal power generator.



**OPTION:** You may also use an extension cord to connect the unit to your charger. More than one charger at a time may be used as long as the total power does not exceed the 20 Watt maximum rating of the pedal generator.

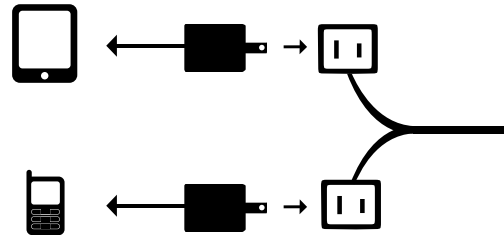

## READY

3

Position yourself, so that your hands or feet are directly over the generator. Pressure from feet (or hands) should be made vertically downward to help hold the generator in places.

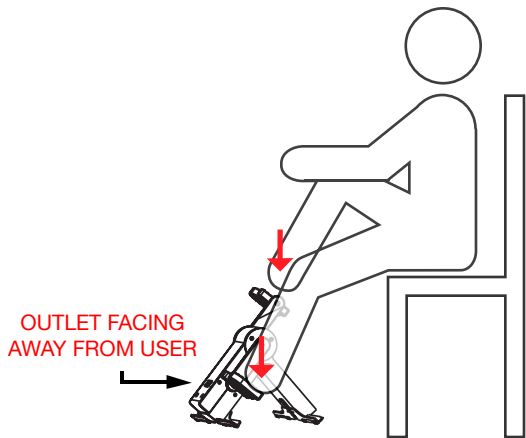

**DO NOT STAND ON THE GENERATOR OR PEDALS**

4

## SPIN

Crank in a forward bicycle motion, accelerating quickly to 90rpm (1.5 rotations per second) for full power and efficient operation.

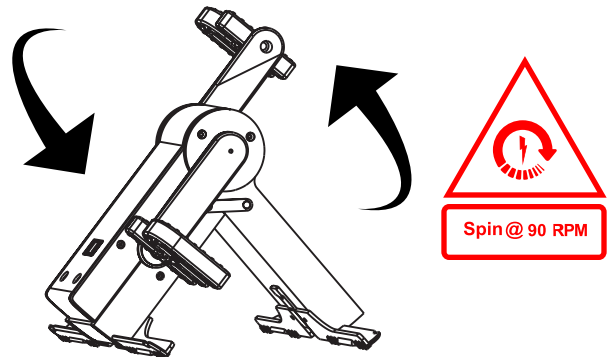

**ACCELERATE QUICKLY TO FULL SPEED 90 RPM**

## OPERATING SUMMARY

- Make sure the pedals are on on the correct crank shaft in the locked position
- Pull on the cranks to insure they are locked on the shaft and will not come off
- Failure to lock the pedals on correctly will damage the unit
- Ensure that the feet pins and base pin are fully inserted
- Make sure the unit is on a flat stable surface, preferably screwed down
- Verify you have enough space to operate the generator
- Check the cord to make sure it will not get caught while operating
- Place pressure vertically downward on the pedals to hold generator in place
- Accelerate quickly to full speed 90 RPM (1.5 revolutions per second)